

Wyke Road Raynes Park, SW20 8RP

£225,000 Leasehold



This well-presented and centrally located ground floor studio apartment has a separate bedroom area, a spacious bathroom and a modern kitchen. Located only 0.2 Miles to Raynes Park with a popular Art Deco Mansion block. Offered to the market with no onward chain.

WYKE ROAD, SW20
 Approx. Gross Internal Floor Area
 247 Sq. ft./22.95 Sq. m

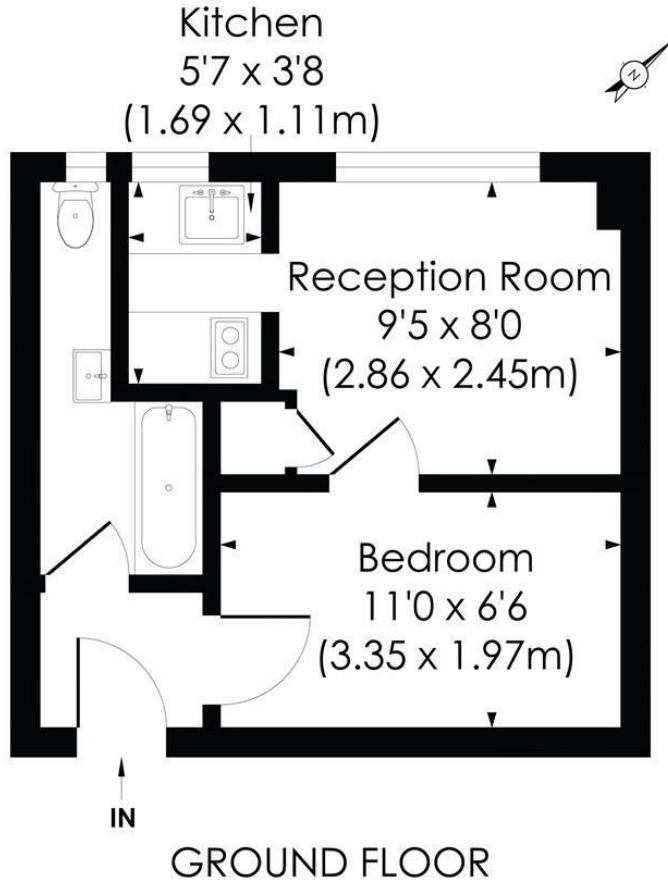

© Pixangle Property Marketing Ltd. info @pixangle.com Tel: 0208 870 2118
 This floor plan has been prepared for illustration purposes only, in accordance with the latest RICS code of measuring and is not to scale.
 All measurements and areas are approximate and whilst every effort has been made to ensure the accuracy of the plan
 contained here, no responsibility is taken for any error, omission or misstatement.

- Ground Floor Studio Apartment
- Subdivided Bedroom Area With Storage
- Modern Kitchen And Bathroom
- 0.2 Miles To Raynes Park Station And High Street
- 186 Year Lease
- No Onward Chain
- Ideal First/Second Time Purchase Or Buy To Let
- Art Deco Mansion Development
- EPC - C
- Council Tax Band - A

Energy Efficiency Rating		Current	Possible
Very energy efficient - lower running costs	A		
(81-91)	B		
(69-80)	C		
(55-68)	D		
(39-54)	E		
(21-38)	F		
(1-20)	G		
Not energy efficient - higher running costs			
England & Wales		69	77
		EU Directive 2002/91/EC	

For Free Mortgage Quote and Best Mortgage Rates, call Ellisons Mortgage Advisor on 0208 944 9595



Although these particulars are believed to be correct, their accuracy is not guaranteed and they do not form part of any contract.

Celebrating 30 years of successful Sales and Lettings in Merton

